

Cleanacres Machinery Ltd Hazleton, Cheltenham, Glos GL54 4DX
 Tel: +44(0) 1451 860721 Fax: +44 (0) 1451 860139



ASA Heavy Duty Trailer Sprayer with steering axle 3000 - 4000 Litre capacity Boom widths 18 - 36 Metres Airtec or Conventional



ATLAS Self Propelled Sprayer 130 -190 Hp Capacity 2000 - 4000 Litre, Load sensing hydra pneumatic suspension Boom widths 18 -36 metres. Shown with 30m Alloy Boom

CROPSAVER EU @ ES tracking trailer sprayer 2500 - 3600 Litre capacity 12 - 30 metre booms Fully tracking , Smart Trak, Continental or Rigid Drawbars Airtec or Conventional.



CROPSAVER mounted sprayer, 800 -1200 Litre capacity, 12 -24 metre booms, Airtec or Conventional.



Full range of demounts sprayers from 2000 - 3000 Litres to fit JCB, Fendt Xylon, Stretched Fastrac, Unimogs, MB Trac's etc



Miser Airtec Band Sprayer 6, 12, or 18 row or bed system, 350 litre tank covers 14 Ha per fill

How Airtec Works

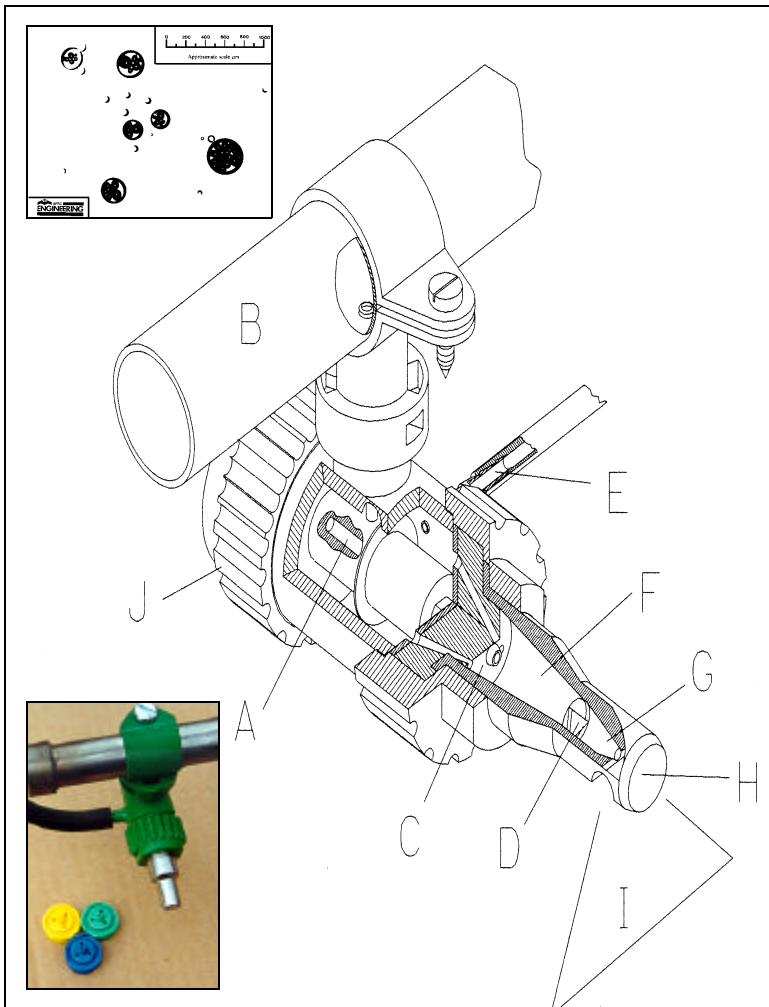

Airtec® Twin Fluid Jet. In operation a conventional pump feeds the **Spray Liquid (A)** into the nozzle via the **Spray Line (B)**. It is directed via the **Interchangeable Restrictor (C)** onto the **Baffle Plate (D)** when primary atomisation occurs. The droplets that are produced are then mixed with compressed air included through the **Airline (E)** in the **Swirl chamber (F)** the compressed air then forces the droplets through the **Circular Passage (G)** onto the inner face of the **Flood Jet (H)**. There, secondary atomisation takes place, prior to the spray emerging in a 110 degree **Flat Fan Pattern (I)**. When the liquid supply is switched off the **Diaphragm Check Valve (J)** prevents drips.

Airtec typically operates at water volumes of 75 litre per hectare, but can if required apply volumes up to 250 litres per hectare with a change of restrictor. Restrictor outputs Green 35 (50 - 120 L/ha) Blue 40 (60 - 150 L/ha) Yellow 50 (90 - 250 L/ha). Across this range of output Airtec produces spray qualities from very fine through to coarse.

Airtec droplets contain air bubbles that are created from the high volume air compressor mounted on the sprayer. These air bubbles mean that a far greater proportion of the droplets are retained on the target.

Unlike other air induction nozzles, Airtec puts energy into the spray stream with the compressor, which means you can select a spray quality from Very Fine to Coarse, so Airtec will produce a spray quality for any application you will ever have to make.

To get the best out of this versatile system, the Magic Box 2 allows you to dial in the Spray Quality & Application Volume, and thereafter maintains these irrespective of forward speed. Where Airtec kits have been fitted to other makes of sprayer and a liquid control system already exists, The Airtec Quality Controller can be fitted to give automatic control of spray quality. This instrument will work with any flow based liquid controller.

